

Monday through Friday, except holidays.  
9:00 a.m. - 5:00 p.m., Central Time

**701-251-1427**

P.O. Box 508 • Jamestown, ND 58402-0508

**AGRI-COVER, INC.**

# **ROLL-UP COVER™**

## **OWNER'S MANUAL**

**INSTALLER:** These instructions and warranty card must be given to the consumer.

**CONSUMER:** Retain these instructions for future use.

**READ ALL INSTRUCTIONS CAREFULLY BEFORE INSTALLING OR USING THIS COVER.**



# CONTENTS

---

■ PARTS LIST AND DESCRIPTION . . . . .	1	■ SAFETY INFORMATION . . . . .	5
■ INSTALLATION INSTRUCTIONS . . . . .	2-4	■ TROUBLE SHOOTING . . . . .	6
■ OPERATING INSTRUCTIONS . . . . .	5	■ WARRANTY . . . . .	7
■ INSPECTION AND MAINTENANCE . . . . .	5		

## FOR YOUR RECORDS:

DATE PURCHASED _____
WHERE PURCHASED _____
SERIAL NUMBER _____

If you find a part, or parts missing or defective, or if you're having trouble installing your new pickup cover, call the customer service number on the back page. **It is recommended that you take the time to review all the material in this manual, even if already familiar with the product, because often changes are made without prior notice.**

This limited warranty does not cover any damage due to accident, abuse, misuse, alteration, neglect, improper installation, or ordinary wear and tear.

This limited warranty gives you specific legal rights and you may have other rights, which vary, from state to state.

Agri-Cover, Inc.  
Customer Service Dept.  
Hwy. 281 N  
PO Box 508  
Jamestown, ND 58402  
Phone: 701-251-1427

U.S. Patent Nos. 5,076,338; 5,174,353; 6,543,835; 6,672,644; and other patents pending.

# MANUFACTURER'S LIFETIME LIMITED WARRANTY

Agri-Cover, Inc. extends the following lifetime limited warranty to the original retail purchaser of any Roll-Up Covers purchased after July 1, 2002:

Agri-Cover, Inc. warrants its Roll-Up Cover to be free from defects in material and workmanship for as long as the original purchaser owns the truck on which the cover was originally installed and as long as the cover remains continuously installed on said truck.

Agri-Cover's sole obligation under this limited warranty is limited to the repair or replacement, at its option, of defective parts only. No labor or service allowance is given or implied. IN NO EVENT SHALL AGRI-COVER, INC. BE LIABLE FOR INCIDENTAL, CONSEQUENTIAL, OR SPECIAL DAMAGES. AGRI-COVER, INC. EXPRESSLY DISCLAIMS ANY AND ALL IMPLIED WARRANTIES OF MERCHANTABILITY, AND THERE ARE NO WARRANTIES WHICH EXTEND BEYOND THE LIMITED WARRANTY DESCRIPTION CONTAINED HEREIN.

For warranty performance call our Customer Service Department at 701-251-1427 to determine if only a replacement part is needed or if the cover needs to be returned for inspection and repair. Warranty registration must be on file and/or proof of original purchase (detailed and dated receipt) required for warranty to be effective. Goods to be returned must have a pre-authorized RGA # (Returned Goods Authorization Number) – obtained by calling the number above. Mark the number on the package and ship it freight prepaid to address below. Agri-Cover will pay freight to return goods to sender.

KEY NO.	DESCRIPTION
1	Left Rail (Drivers Side)
2	Right Rail
3	Roll-Up Bar
4	Front Bar
5	EZ-DIAL Left Tension Adjuster Assy.
6	EZ-DIAL Right Tension Adjuster Assy.
7	Support Bows (3 Per Cover) (2 On Some Short Boxes)
8	Cover Assy.
9	Rail Clamps w/Bolts (6 Per Cover)
10	3/8x1-1/4 Bolt, Washer (2 Per Cover)
11	3/8x3/4 Bolt, Washer, Nut (2 Per Cover)
12	Spring Action Latch w/Pull Cord
13	Nylon Strikes (Hidden On View) With Molded in Bolt and Nut (2 Per Cover)
14	Quick Release Stor. Strap (2 Per Cover)
15	Slide Lock (1 Per Cover)
	Owners Manual

**PARTS LIST**

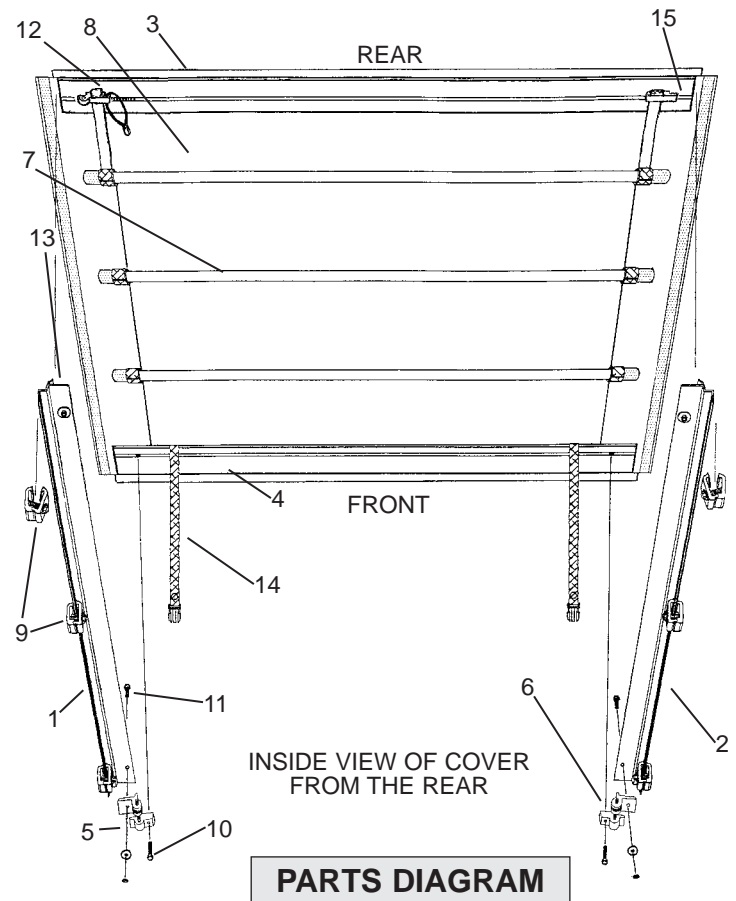

**PARTS DIAGRAM**

# INSTALLATION INSTRUCTIONS

## TOOLS & EQUIPMENT NEEDED

- A. Two 9/16" box wrenches
- B. One 1/2" box wrench
- C. Impact wrench with 9/16" socket
- D. Household weigh scale (for adjusting cover tension)
- E. Two vise-grip type C-clamps (for holding rail to pickup box)
- F. Protective eye wear

**NOTICE TO INSTALLER:** ALWAYS HANDLE COVER AND ITS COMPONENTS WITH CARE TO AVOID DAMAGE.

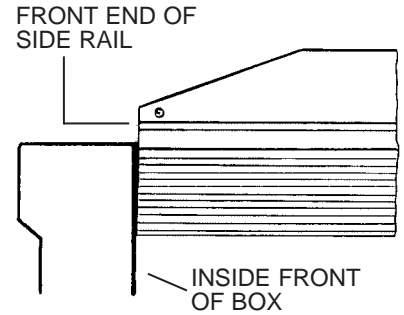

**ILLUSTRATION 1**

## STEP 1: POSITIONING THE SIDE RAILS

### INSTALLATION TIP:

The front end of the rail is the end with the hole. The rear end of the rail has the nylon strike bracket.

- A. Place the mounting portion of the rail against the upper inside wall of the box. Slide the rail forward until the front end stops against the inside front of the box. (See *Illustration 1 and 2*). Use two vise-grip C-clamps to temporarily clamp the rail to the box. Setting of vise-grip clamp should be only snug tight.
- B. Adjust the height of the rail by positioning **the edge of the rail flush with or slightly higher than the top of the box.** (See *Illustration 2*)
- C. At the tailgate end, adjust the edge of the side rail even with the top of the tailgate or tailgate protector. (See *Illustration 3*). (Example: if tailgate protector is 1/8 inch thick, raise the rear of the rail 1/8 inch).

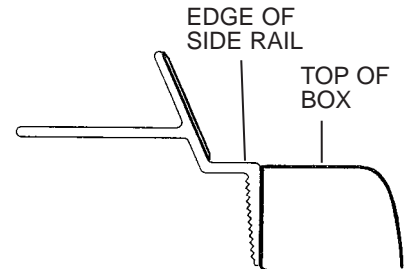

**ILLUSTRATION 2**

<p>COVER IS TOO WIDE...</p> <p>TOO NARROW...</p>	<p>...CHECK RAILS.</p> <p>RAILS IN - TOO WIDE - PUSH ALL CLAMPS TO TOP OF RAIL.</p> <p>RAILS OUT - TOO NARROW - PULL ALL CLAMPS DOWN ON RAIL.</p> <p>(Refer to Step 2)</p>
<p>LOPSIDED COVER TOO MUCH ON ONE SIDE...</p>	<p>...CHECK FRONT BAR. IT MUST BE CENTERED SIDE TO SIDE.</p>
<p>TOP OF TAILGATE HITS REAR BAR WHEN ATTEMPTING TO CLOSE...</p>	<p>...RAISE SIDE RAILS AT REAR OF BOX UNTIL TAILGATE CLOSES WITHOUT PUSHING REAR BAR UP.</p> <p>(Refer to Step 2)</p>
<p>NYLON LATCH DOESN'T ENGAGE...</p>	<p>...COVER TOO LOOSE. FIRST SET PROPER COVER TENSION.</p> <p>(Refer to Step 4 and 5)</p>

# TROUBLESHOOTING

PROBLEM	SOLUTION
COVER TOO LOOSE...	...TURN BOTH TENSION ADJUSTERS COUNTER CLOCKWISE TO MOVE FRONT BAR FORWARD. (Refer to Step 4)
COVER TOO TIGHT...	...TURN BOTH TENSION ADJUSTERS CLOCKWISE TO MOVE FRONT BAR REARWARD. (Refer to Step 4)
GAP BETWEEN ROLL-UP BAR AND TAILGATE...	...RAILS SET TOO HIGH. (Refer to Step 2)

## STEP 2: FASTENING THE SIDE RAILS

A. There are 3 clamps provided for each rail. Beginning at the front, place a clamp about 8" or closer from the end and tighten with 9/16" wrench. Position the clamp up or down as needed to level the rail. Next place a clamp at the center of the rail and tighten it. Then place a 3rd clamp 8" or closer from the back end. While holding rear of rail at proper height for tailgate and tailgate protector, tighten clamp. *See Illustrations 2 and 3 for proper rail height.* Make sure all clamps are tight.

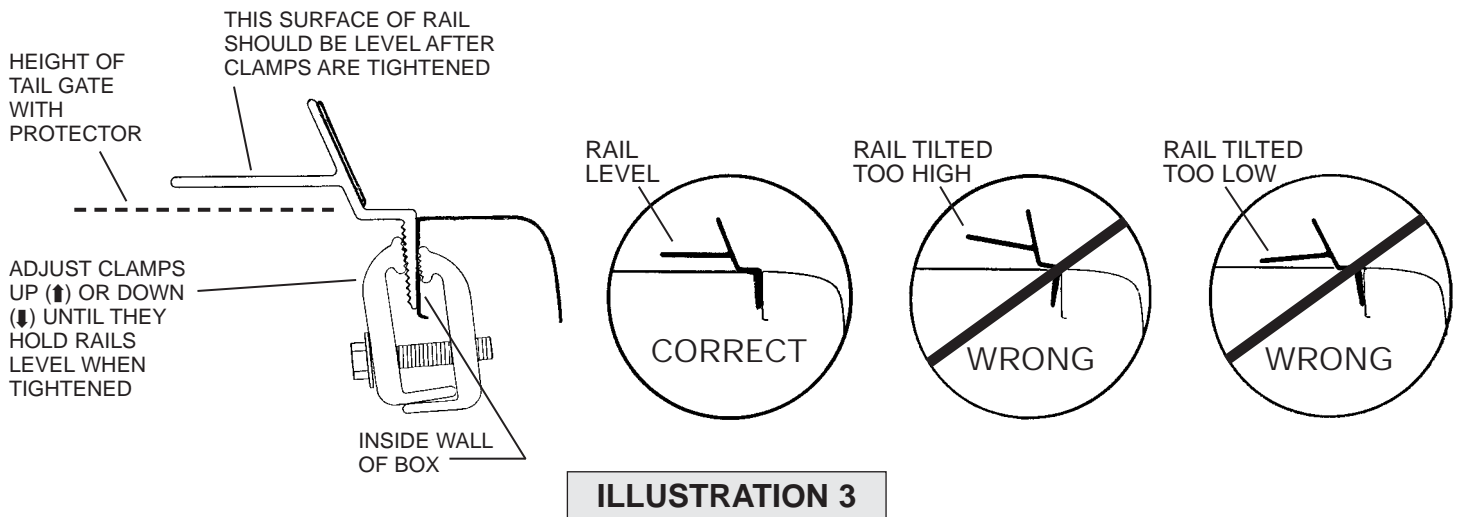

### IMPORTANT BEFORE PROCEEDING TO NEXT STEP:

1. Make sure that the rails are flush with or slightly higher than top of the box on sides. If tailgate has a protector the back of rail must be flush with top of tailgate protector to ensure the cover closes properly.
2. Make sure the rails are level and clamps are tight.

# INSTALLATION INSTRUCTIONS

## STEP 3: MOUNTING THE COVER

- A. Remove cover from plastic wrapping. Leave cover rolled up as the outer bar is the front bar. There are two nuts in the channel (one for each tension adjuster assembly) on the under side of the front bar. The tension adjuster assemblies are marked "L" for left hand (driver side) and "R" for right hand. Attach the front clamp of the tension adjuster assembly to the bottom of the front bar by inserting bolt through washer, clamp, and thread into the nut in the channel of the front bar. Leave bolt loose for now, so tension adjuster assembly can slide in the front bar. Attach both tension adjusters in this manner. (See *Illustration 4 and 5*)
- B. Place the front bar (with cover in rolled up position) on the front flat portion of the side rails. Center front bar between the side rails. Make sure the skirt sewn on the front edge is tucked under the front bar facing to the inside of the box. This will be the starting point before fine adjustments are made. (See *Illustration 4*)

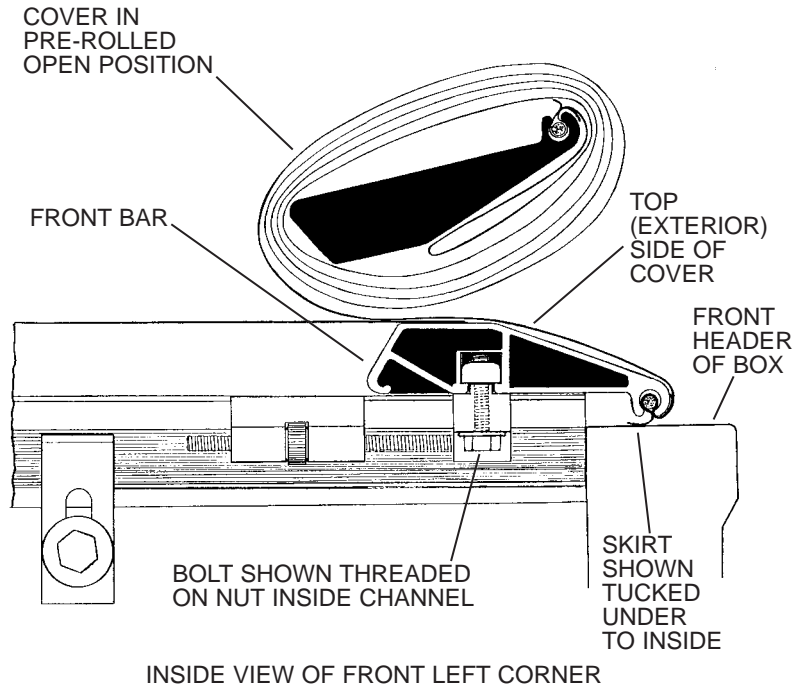

ILLUSTRATION 4

### INSTALLATION TIP:

The cover assembly is packaged in the pre-rolled open position for ease of installation.

## INSPECTION AND MAINTENANCE

- Inspection and much of the maintenance can be done by the operator. It may be necessary to review the installation and operating instructions.
- Periodically inspect the cover assembly. Check for loose bolts and parts and the condition of all parts. Test the operation to ensure that the parts are functioning properly and that the cover is in top operational condition.
- If nylon latch has been damaged replace with new one.

**NOTE:** Inspection and/or maintenance should also be performed anytime a malfunction is observed or suspected.

If you need assistance inspecting and/or servicing your cover, or if you want to order a replacement part, call the customer service number on the back page.

- Vinyl cover can be treated with vinyl protectants. Avoid silicon base products.
- Never clean cover with petroleum or citrus base products. Use mild soap and water.

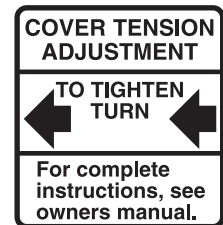

## SAFETY INFORMATION

- Do not cover cargo that is higher than the cover.
- Do not place object on or against the cover or its framework at any time.
- Always secure cargo so cargo can not shift and damage the cover or its parts.
- Do not use the covers' framework to tie down cargo.
- Never stand, sit or ride on the cover or allow others to do so.
- Do not leave valuables in an unattended vehicle as the cover does not prevent theft of contents in the truck box.
- The cover does not eliminate moisture and dust from entering the truck box. Special wrapping or packaging of the contents may be necessary.
- Due to poor ventilation, if you allow a pet animal in the box, leave cover open. Do not allow people or animals to occupy box with the cover closed.
- When towing vehicle backwards, cover must be rolled fully open and secured with safety straps or fully closed and secured with manual slide lock.



# OPERATING INSTRUCTIONS



Unroll to close. Roll-up to open.



Push down to close. Pull latch to side and lift to open.



Seal hook and loop system on sides to close. Auto-releases when opening.

## STEP 1: CLOSING FROM OPEN POSITION

- Release the retainer straps at the front and using both hands roll the cover out to the rear of box.
- Position the roll-up bar against the strikes. Push down on bar until spring loaded latch locks into place under driver side rail. Optional, for extra security push slide lock into place under passenger side rail.
- Now along the side of the box, seal the cover edges with the hook and loop sealing system the full length of cover on both sides.



### SLIDE-LOCK

When needed, the roll-up bar can be locked from beneath when the tailgate is open. Push to lock, pull to unlock. This feature is used in conjunction with a tailgate lock. (Tailgate locks sold separately.)



Cover rolled fully open with both safety straps secured. **NOTE:** Cover is not rolled against cab to avoid wear on paint and cover.

## STEP 2: OPENING FROM CLOSED POSITION

- Open tailgate - pull slide lock on passenger side if locked, then under driver side rail pull spring loaded latch to side and lift up on rear of roll-up bar.
- Using both hands, roll the cover up toward the front of the box (not against cab.)
- Now, securely fasten the retainer straps to store the cover.

**SAFETY WARNINGS:** ALWAYS FINISH SECURING THE COVER. DO NOT OPERATE COVER IN WINDY CONDITIONS.

- Slide the tension adjuster assembly adjacent to the side rail. Make sure front bar clamp slides under side rail. Insert a 3/8"x3/4" hex bolt through the rail and rear mounting bracket of the tension adjuster assembly. Thread nut on and turn tight. Do this on both tension adjuster assemblies. Next, center the front bar between the side rails. Then tighten the bolt holding the front clamp to the front bar. (See Illustration 5)

### INSTALLATION TIP:

If the hole on tension adjuster does not line up with the hole in the side rail, by hand push the front bar forward or rearward as needed.

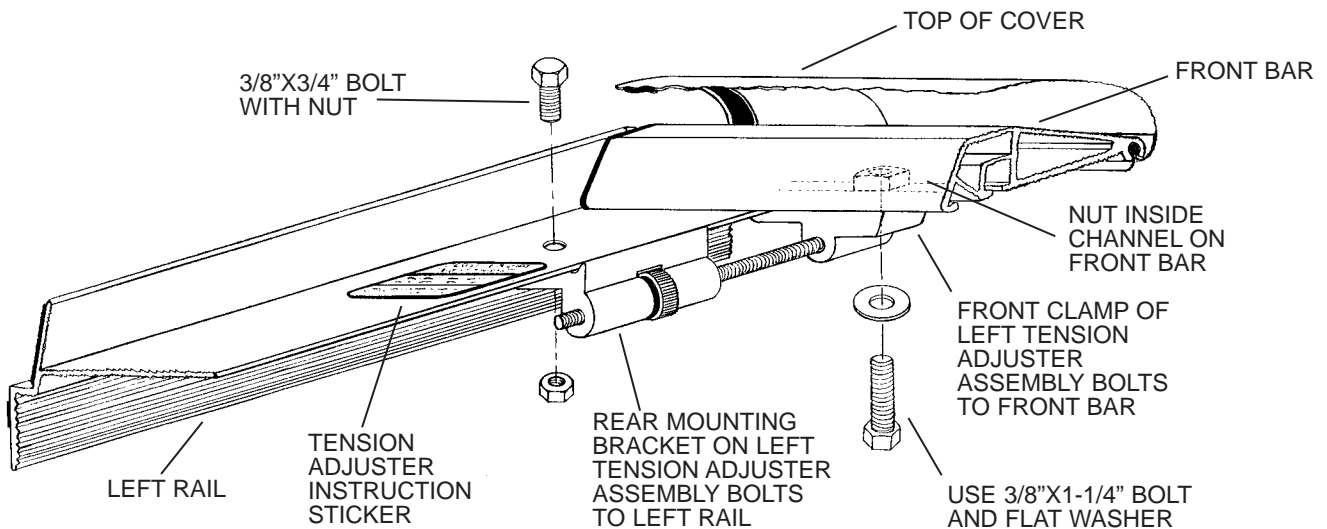

REAR VIEW OF FRONT LEFT CORNER

**ILLUSTRATION 5**

# INSTALLATION INSTRUCTIONS

## STEP 3: CONTINUED

D. Roll cover out to the strikes. Engage rear bar in strikes. (See *Illustration 6*) Press down on bar to close cover. To open, pull latch from left to right, hold, and lift up on the rear of roll bar.

### INSTALLATION TIP:

If you have difficulty with latch locking system, make sure rails at tailgate are set to proper height and level - refer back to *Illustration 3*, page 2.

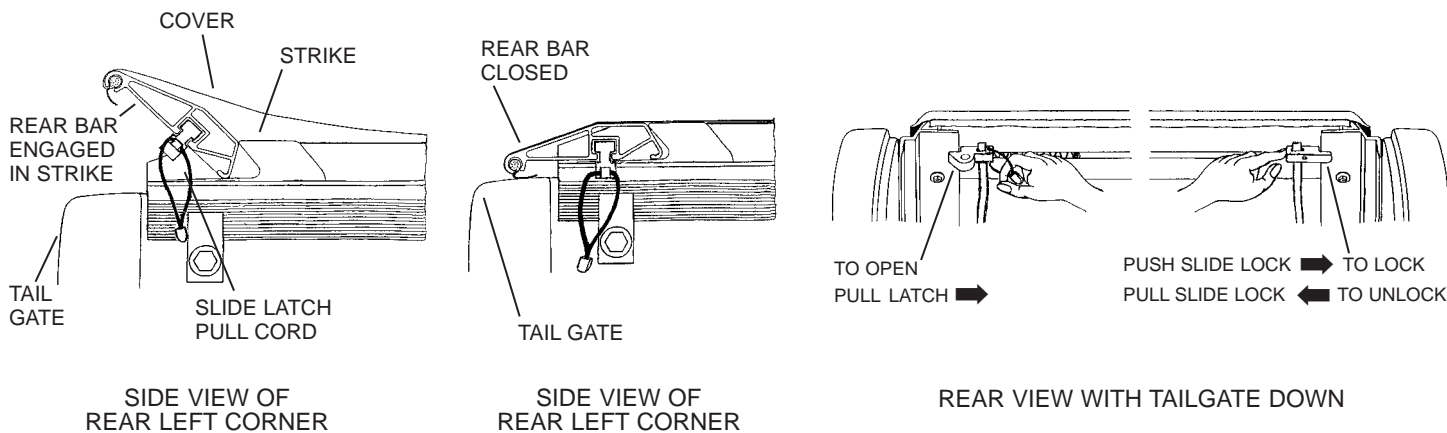

ILLUSTRATION 6

## STEP 4: ADJUSTING THE TENSION OF THE COVER

A. The tension of the cover is adjusted by sliding the front bar forward or backward. This is done with the thumb dial adjuster. Turning the thumb dial counter clockwise will slide the front bar forward – increasing tension on the cover. Turning the thumb dial clockwise will slide the front bar rearward – decreasing the tension on the cover. (See *Illustration 7*) Make final tension adjustments to your cover now. Open roll bar and slowly close it, testing for 30 lbs of pressure. If cover is too loose or too tight open roll bar one-half turn and lift cover up enough to reach in and turn thumb dials on each side. Then close roll bar and retest for pressure, make sure the hook and loop on sides are loose (not sealed) when adjusting and testing cover tension. Repeat until proper tension is achieved. When properly adjusted, cover should be flat and smooth (no sagging between bows) lengthwise.

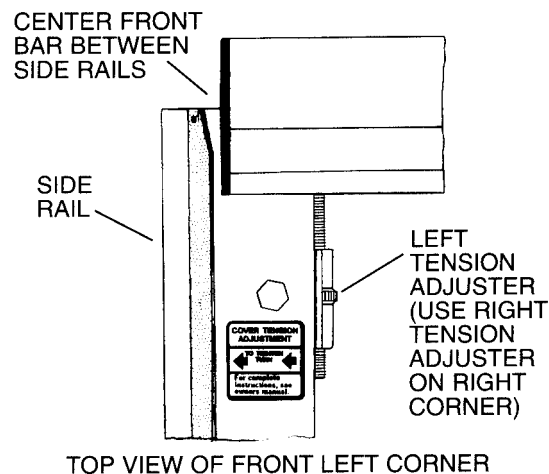

ILLUSTRATION 7

### INSTALLATION TIP:

Place a household weigh scale at rear of box on floor. Stand on scale and read weight. Slowly push down on rear roll bar till closed and read the lowest reading on scale. Subtract this number from the first reading. The net difference is the amount of pounds needed to close rear roll bar. Adjust cover tension to a recommended 30 lbs.