

**Version 3**



# Ram X-Power *Plus* Dodge 5.9L Installation Instructions

**P/N#: 1054520 - 2003-2004 Dodge**

**PLEASE READ ALL INSTRUCTIONS BEFORE INSTALLATION.**  
*These instructions have been modified for Version 3.0 of the RAM Xpower.*

**Please read the disclaimer before proceeding to install this unit. Gauges are highly recommended.**

## Installation

1. Install the negative ground loop to the vehicle's driver side battery ground terminal.
2. Install the RED positive power loop to the vehicle's driver side battery positive terminal.

**You can install a ½" nut on both battery terminals to ease the installation of the power and ground loops.**

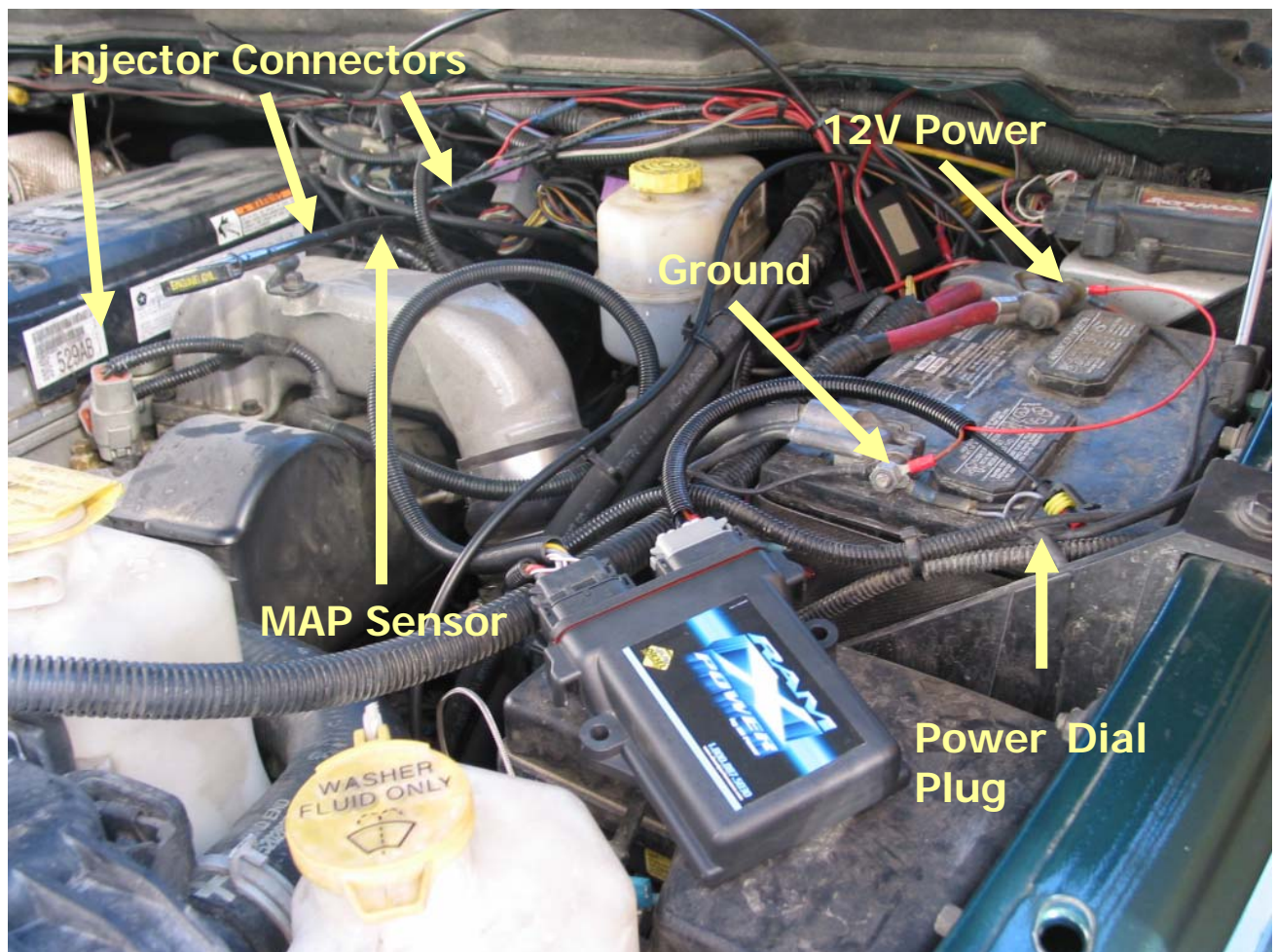

3. Next you can route and install the wiring harness towards the engines cylinder head. You will need to disconnect each factory injector plug and reconnect this plug into the female plug of the Xpower's wiring harness. Now connect the Xpower's male plugs into the factory injector plug receptacles. There will be three connections that need to be made from the front to the back of the engine.

BD Engine Brake Inc.

Plant Address: Unit A10, 33733 King Rd, Abbotsford, BC, Canada V2S 7M9

U.S. Shipping Address: 88-446 Harrison St, Sumas, WA 98295 U.S. Mailing Address: P.O. Box 231, Sumas, WA 98295

Phone: 604-853-6096 Fax: 604-853-8749 Internet: [www.bd-power.com](http://www.bd-power.com)

4. Now you can disconnect the factory MAP sensor, and plug the sensor into the Xpower MAP sensor receptacle. Now connect the Xpower's male MAP sensor into the factory sensor.
5. You can now choose a location to secure the main control Ram Xpower unit. Keep the unit away from any heat sources, moving parts or water sources.
6. Now inside of the cab you will need to choose a good location to mount the power knob. A recommended installation point is just to the left of the steering wheel, there is a relatively flat section there that is easy to access. You will need to drill a hole in the dash to accommodate the power knob. Note that you will need to remove or readjust the backing foam to install the dial.

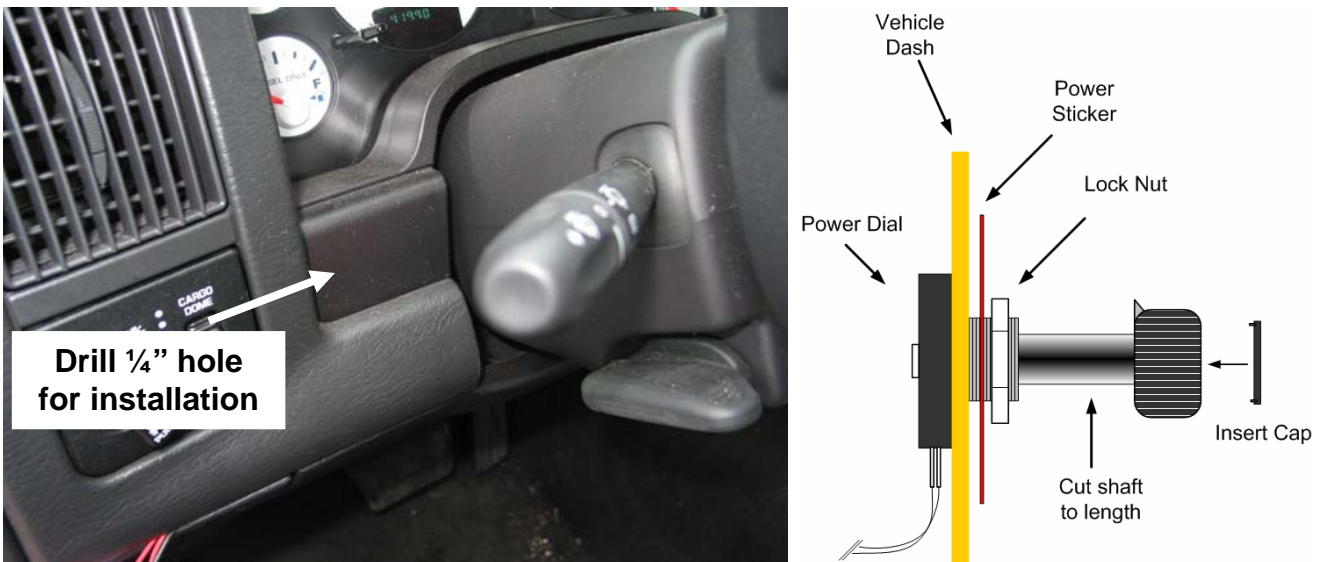

7. Insert the knob through the drilled hole and place the sticker so that the shaft sticks through the center. Be sure that the sticker is perfectly aligned; you can then use the plastic lock nut to hold everything in place. You will need to cut the shaft to the perfect length to protrude just enough so that you can attach the dial knob.
8. Now you can put the power level indicator knob top on the end of the shaft and tighten it with a flat screwdriver. Be sure that the indicator is correctly clocked with the sticker before you lock it in place.
9. You will need to route the two black wires from the back of the adjustable power knob through the firewall and towards the Xpower unit. You'll notice that the plug body has been left off to ease the installation through the firewall.

10. Once the two wires are routed into the engine compartment you may insert the pins into the plug. It does not matter which pin goes into which hole, just be very sure that the pin locks in place and will not dislodge when the two plugs are connected.

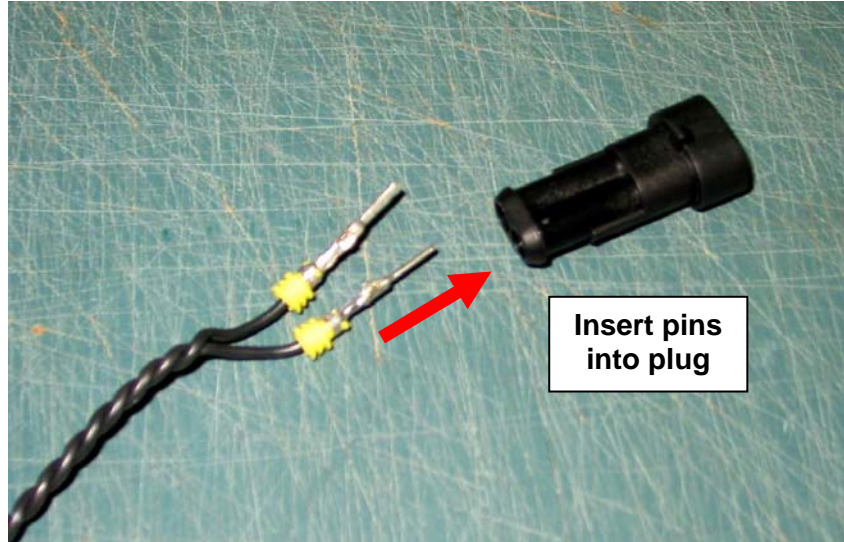

11. Once you have locked the pins in place you may connect the plug the male plug on Xpower control box.

*If you do not connect the power dial, the unit will default to the maximum selected power level.*

Congratulations, you've completed the installation of the new Ram Xpower unit! Take the vehicle for a test drive and adjust the power level using the power dial. Turn the power dial clockwise for more power, counter clockwise for less power.

### Internal Power Level Adjustment

To adjust the unit you will need to remove the protective casing by releasing the locking tabs on both sides of the unit. Once they have been released you should be able to slide the casing off.

Power Level 1	Economy Setting	50 HP Max Gain
Power Level 2	Tow Setting	100 HP Max Gain
Power Level 3	Performance Setting	130 HP Max Gain
Power Level 4	Race Setting	160 HP Max Gain

**NOTE! POWER LEVEL 4 IS ONLY FOR AFTERMARKET TURBOCHARGERS AND MODIFIED TRUCKS!**

BD Engine Brake Inc.

Plant Address: Unit A10, 33733 King Rd, Abbotsford, BC, Canada V2S 7M9

U.S. Shipping Address: 88-446 Harrison St, Sumas, WA 98295 U.S. Mailing Address: P.O. Box 231, Sumas, WA 98295  
Phone: 604-853-6096 Fax: 604-853-8749 Internet: [www.bd-power.com](http://www.bd-power.com)

If the jumpers are not set correctly or the model years are not correctly matched you may set an over boost code or suffer from a lack of power.

**2003-2004 Vehicles**

Power Level 1	Power Level 2	Power Level 3	Power Level 4
● ● ● ● ● ●	● ● ● ● ● ●	● ● ● ● ● ●	● ● ● ● ● ●

IT IS ALWAYS SUGGESTED TO ALLOW YOUR VEHICLE TO WARM UP TO OPERATING TEMPERATURE BEFORE APPLYING POWER. IF EXCESSIVE POWER IS ADDED WHEN THE VEHICLE IS COLD, A CHECK ENGINE LIGHT MAY BE SET AND THE VEHICLE MAY RUN POORLY. IF THIS HAPPENS, YOU CAN CYCLE THE KEY A NUMBER OF TIMES TO CLEAR THE CODE.

**DISCLAIMER OF LIABILITY**

Other than as expressly set forth herein, BD ENGINE BRAKE, Inc. (hereafter collectively, "SELLER"), together with its distributors, jobbers and dealers shall in no way be responsible for the PRODUCT'S proper use and service. In no event shall SELLER be liable for any special, incidental, indirect or consequential damages of any kind or nature, whether or not BUYER was advised of the possibility of damage, arising or resulting from the use or performance of the PRODUCT, and BUYER hereby waives any and all such claims.

BUYER acknowledges that he/she/it is not relying on SELLER'S skill or judgment to select or furnish goods suitable for any particular purpose and that SELLER has no liability that will extend beyond the scope of the limited warranty contained herein, and BUYER hereby waives all remedies or liabilities, expressed or implied, arising by operation of law or otherwise, (including, without limitation, any obligations of SELLER with respect to fitness for any particular purpose; merchantability; and special, incidental, indirect or consequential damages) or whether or not occasioned by SELLER'S negligence.

SELLER disclaims any warranty and expressly disclaims any liability for personal injury or damages related to BUYER'S use of the PRODUCT. BUYER acknowledges and agrees that the disclaimer of any liability for personal injury is a material term for this agreement and BUYER agrees to indemnify SELLER and hold SELLER harmless from any claim related to the PRODUCT and its use or performance. Under no circumstances will SELLER be liable for any damages, liabilities, costs or expenses incurred as a result of by reason of the use, performance or sale of the PRODUCT, including, without limitation, any damages, liabilities, costs or expenses incurred by reason of BUYER'S negligence related to those uses of the PRODUCT as a result of the removal of the speed limiter.

SELLER assumes no liability regarding the improper installation or misapplication of the PRODUCT. It is the installer's responsibility to check for proper installation, and, if in doubt, contact the manufacturer.

**LIMITATION OF WARRANTY**

SELLER hereby provides the following limited warranty as to description, quality, merchantability, fitness for any product's purpose, productiveness, or any other matter of SELLER'S product sold herewith. The SELLER shall be in no way responsible for the product's open use and service and the BUYER hereby waives all rights other than those expressly written herein. This Warranty shall not be extended or varied except by a written instrument signed by SELLER and BUYER.

The Warranty is Limited to one (1) year from the date of sale and limited solely to the parts contained within the product's kit. All products that are in question of Warranty must be returned shipping prepaid to the SELLER and must be accompanied by a dated proof of purchase receipt. All Warranty claims are subject to approval by BD ENGINE BRAKE, Inc.

Under no circumstances shall the SELLER be liable for any labor charged or travel time incurred in diagnosis for defects, removal, or reinstallation of this product, or any other contingent expenses.

Under no circumstances will the SELLER be liable for any damage or expenses insured by reason of the use or sale of any such equipment.

IN THE EVENT THAT THE BUYER DOES NOT AGREE WITH THIS AGREEMENT: THE BUYER MAY PROMPTLY RETURN THIS PRODUCT, IN A NEW AND UNUSED CONDITION, WITH A DATED PROOF OF PURCHASE, TO THE PLACE OF PURCHASE WITHIN THIRTY (30) DAYS FROM DATE OF PURCHASE FOR A FULL REFUND. THE INSTALLATION OF THIS PRODUCT INDICATES THAT THE BUYER HAS READ AND UNDERSTANDS THIS AGREEMENT AND ACCEPTS ITS TERMS AND CONDITIONS.

BD Engine Brake Inc.

Plant Address: Unit A10, 33733 King Rd, Abbotsford, BC, Canada V2S 7M9

U.S. Shipping Address: 88-446 Harrison St, Sumas, WA 98295 U.S. Mailing Address: P.O. Box 231, Sumas, WA 98295

Phone: 604-853-6096 Fax: 604-853-8749 Internet: www.bd-power.com